

Georgetown Square

Designed by Lori Hein

Featuring Aubrey by Whistler Studios

SIZE: 65" x 81"

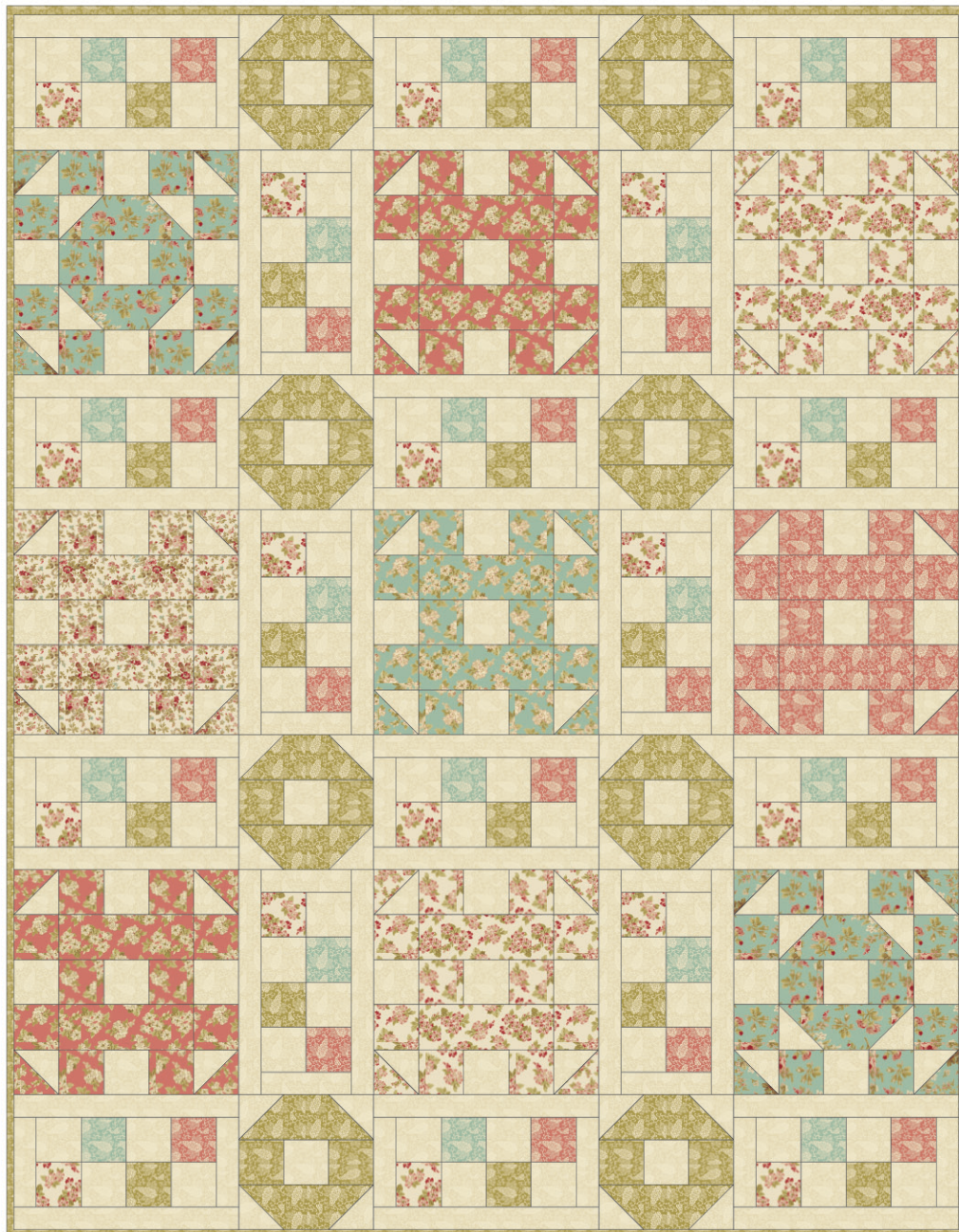

FREE
PROJECT

THIS IS A DIGITAL REPRESENTATION OF THE QUILT TOP, FABRIC MAY VARY.

PLEASE NOTE: BEFORE MAKING YOUR PROJECT, CHECK FOR ANY PATTERN UPDATES AT WINDHAMFABRICS.COM'S FREE PROJECTS SECTION.



Georgetown Square

KEY	FABRIC	SKU	YD	CUTTING INSTRUCTIONS
A		42647-1 Cream	1/2	(1) 4" x WOF strip; subcut (2) 4" squares and (2) 3 1/2" x 9 1/2" pieces (2) 3 1/2" x WOF strips
B		42647-2 Aqua	1/2	(1) 4" x WOF strip; subcut (4) 4" squares (3) 3 1/2" x WOF strips; subcut 1 strip into (4) 3 1/2" x 9 1/2" pieces
C		42648-1 Cream	3/4	(1) 4" x WOF strip; subcut (4) 4" squares (5) 3 1/2" x WOF strips; subcut 1 strip into (4) 3 1/2" x 9 1/2" pieces
D		42648-2 Aqua	1/2	(1) 4" x WOF strip; subcut (2) 4" squares and (2) 3 1/2" x 9 1/2" pieces (2) 3 1/2" x WOF strips
E		42648-3 Coral	1/2	(1) 4" x WOF strip; subcut (4) 4" squares (3) 3 1/2" x WOF strips; subcut 1 strip into (4) 3 1/2" x 9 1/2" pieces
F		42649-3 Coral	5/8	(1) 4" x WOF strip; subcut (2) 4" squares and (2) 3 1/2" x 9 1/2" pieces (4) 3 1/2" x WOF strips
G		42649-1 Cream	3 7/8	(2) 15 1/2" x WOF strips; subcut into (36) 2" x 15-1/2" pieces (2) 6 1/2" x WOF strips; subcut into (36) 2" x 6-1/2" pieces (2) 4" x WOF strips; subcut (18) 4" squares (23) 3 1/2" x WOF strips; subcut 7 strips into (68) 3 1/2" squares
H		42649-2 Aqua	1/3	(2) 3 1/2" x WOF strips
I		42649-4 Moss	1 5/8	(10) 3 1/2" x WOF strips; subcut 4 strips into (16) 3 1/2" x 9 1/2" pieces (8) 2 1/4" x WOF strips for binding
		Backing	5	
				73" x 89" piece of batting



Georgetown Square

15" square finished Main Block

1. Sew **B** 3 1/2" x WOF strips lengthwise to opposite sides of 1 **G** 3 1/2" x WOF strip. Crosscut into 10 – 3 1/2" wide V segments.



2. Draw a diagonal line on the wrong side of 2 **G** 3 1/2" squares. Lay marked squares on opposite ends of 1 **B** 3 1/2" x 9 1/2" piece. Stitch on the drawn lines, trim seam allowance to 1/4", and press open. Make 2 W units.

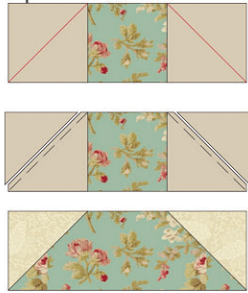

3. Draw a diagonal line on the wrong side of 2 **G** 4" squares. Lay each marked square right sides together with a **B** 4" square. Sew 1/4" on either side of the drawn line, cut on the line, and press units open. Trim to measure 3 1/2" square. Make 4 HSTs.

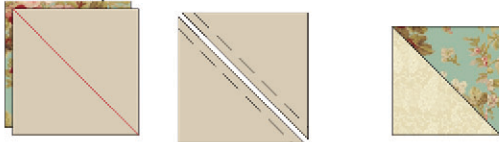

4. Lay out 2 W units and 1 V segment make the block center. Sew the units together. Sew V segments to opposite sides. Sew HSTs to both ends of 2 V segments and sew to the top and bottom of the block center to complete the block. Make a second B block.





Georgetown Square

5. Repeat steps 1-4 to make 2 blocks each using **C** and **E** and 1 block each using **A**, **D** and **F**. Note that for the A, D and F blocks, you'll only need to cut 5 V segments from the strip set.

9" square finished Ring Block

1. Sew **I** 3 1/2" x WOF strips lengthwise to opposite sides of 1 **G** 3 1/2" x WOF strip. Make 2. Cross-cut into 16 - 3 1/2" wide V segments.



2. Draw a diagonal line on the wrong side of 4 **G** 3 1/2" squares. Lay the marked squares on opposite ends of 1 **I** 3 1/2" x 9 1/2" piece. Stitch on the drawn lines, trim seam allowance to 1/4", and press open. Make 2 W units.

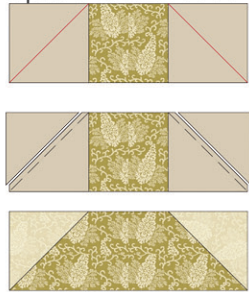

3. Lay out 1 V segment and 2 W units as shown. Sew the units together to complete the block. Make a total of 8 ring blocks.

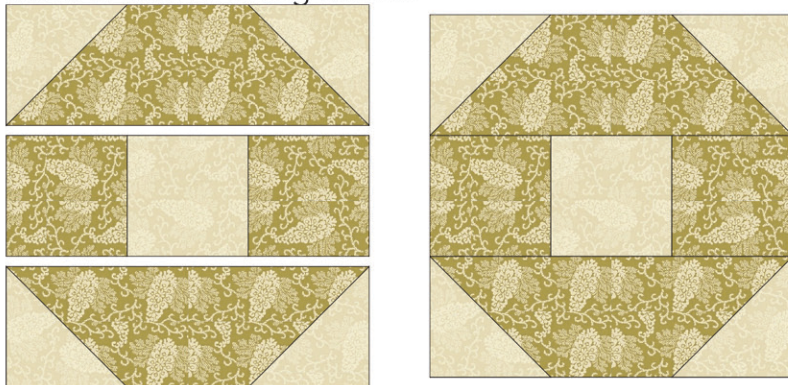



Georgetown Square

9" x 15" finished sashing units

1. Sew the following 3 1/2" x WOF strips together lengthwise: **C, G, I, G**. Make 2. Crosscut into 18 – 3 1/2" Y segments.



2. Sew the following 3 1/2" x WOF strips together lengthwise: **G, H, G, F**. Make 2. Crosscut into 18 – 3 1/2" Z segments.



3. Sew each Y segment to a Z segment. Sew **G** 2" x 6 1/2" pieces to the top and bottom. Sew **G** 2" x 15 1/2" pieces to the side to complete a sashing unit. Make a total of 18 sashing units.

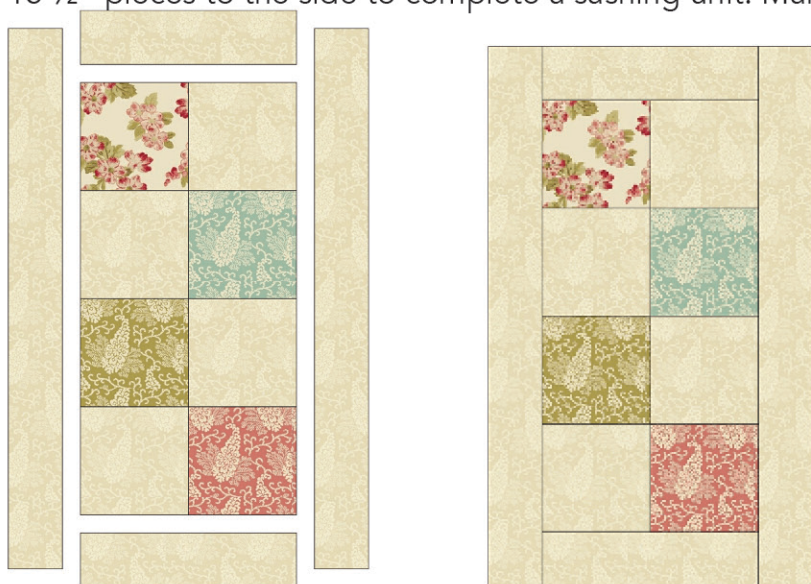



Georgetown Square

Assembly

1. Lay out 3 sashing units alternating with 2 ring blocks to create a sashing row. Sew the units into a row. Make 4.
2. Referring to the Quilt Layout Diagram for block color placement, lay out 3 blocks alternating with 2 sashing units. Join the units into a row. Make 3.
3. Sew the sashing rows alternating with the block rows to complete the quilt.
4. Lay the backing face down, batting and quilt top face up. Baste the layers together and quilt as desired. Use the 8 | 2 1/4" x WOF strips to bind the quilt.

Quilt Layout Diagram

